



LEO 2048-L56gm

- 2K @56 KHz
- Adopts GigE interface and max. transmission distance of 100 meters without relay
- Compatible with GigE Vision Protocol, GenICam Standard, and the third-party software based on these protocol and standard
- Support Windows、Linux
- Up to 128 MB local memory for burst transmission and retransmission



**Applied range** • Printing • Textile • Railway • Logistics • Metallurgy • Food • Pharmaceutical • Material sorting

Camera	LEO 2048-L56gm
Resolution [H*V]	2048 × 1
Sensor Type	CMOS
Pixel Pize [ $\mu\text{m}$ ]	7 × 7
Line Frequency [KHz]	56
Data Bit	8bit / 10bit / 12bit
Exposure Time	2 $\mu\text{s}$ ~10ms
Dynamic Range	60dB
Mono/Color	Mono
Image Format	Mono8/10/10p/12/12p
Interface	GigE
Synchronization	Via hardware trigger、software trigger or free run mode
Programmable Control [ISP]	Image resolution、Exposure time、 Contrast ratio、 Gamma form、 Image rollovers、 Raw、 LUT、 Black level correction
Housing Size [l*w*h]	62.0 × 62.0 × 37.5 mm (170g)
Operating Temperature	-30~70 ° C (Storage), 0~50° C (Working)
Lenses Mount	M42*1.0, BFL 12 mm
Digital I/O	Opto-isolated input x 1, opto-isolated output x 1, and bi-directional custom non-isolated I/O x 1
Power Input	DC 12V, Supporting PoE
Power Consumption	12V @4.0W
Driver	LEO Series Camera Software Suite (iDatum) or 3rd party GigE Vision Software
Operating System	Windows, Linux
Conformity	GigE Vision, GenICam

### Spectral Response

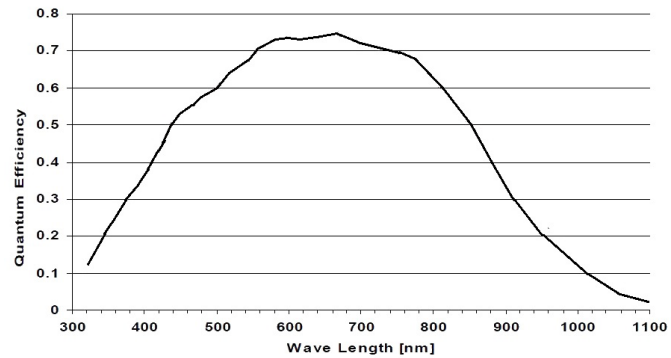

### Dimensions

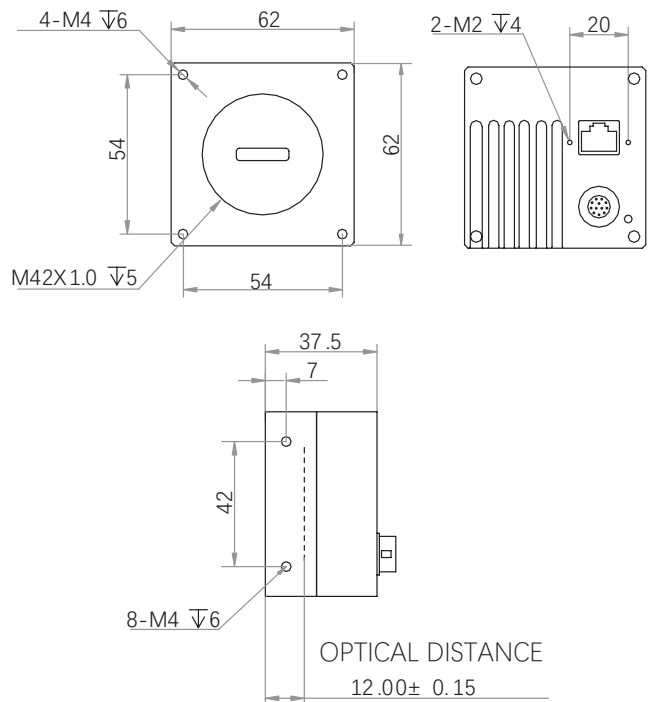

No.8, Xiyuan 9th Road West Lake District, Hangzhou 310030 China  
 Tel: 86-571-86888309, 86-571-86888307  
 Web: [www.visiondatum.com](http://www.visiondatum.com) Email: [market@visiondatum.com](mailto:market@visiondatum.com)

