

BTLM SERIEr

NEW

2
BTLM



Variable Iris Bi-telecentric Lenses

BTLM series bitelecentric lens are designed and optimized for high accuracy measurement application. These lenses feature variable iris for Depth of Field and resolution adjustment, big F/# for high pixel camera and one style design which is easy for industrial manufacture.

PRODUCT FEATURES

- 1. Support up to 8M Pixel cameras;
- 2. Zero perspective error over the entire Field of View;
- 3. Big depth of field and constant magnification over defined depth of field;
- 4. Customization available with best performance/cost rate;
- 5. Equipped with a Manual Iris for adjusting the Depth of Field.

NAMING RULES

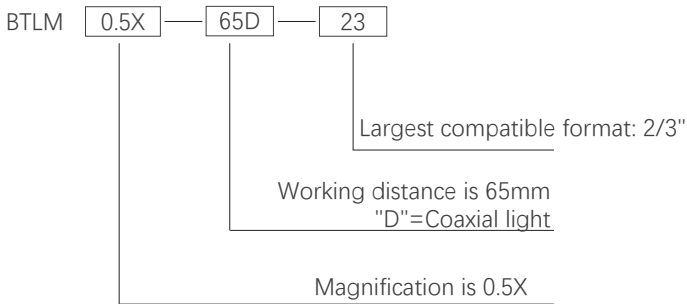

BTLM-0.3X-110-23

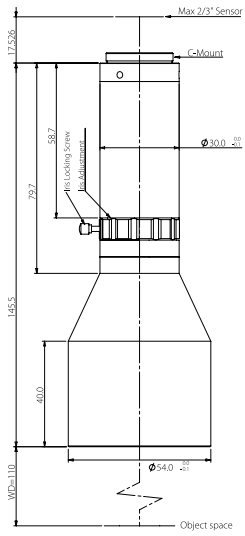

FOV(Φmm)	37
Mag.(x)	0.300
WD(mm)	110±2
Max Sensor Size(Φmm)	11.0(2/3")
F/#	3.75
MTF30(lp/mm)	>220
DoF(mm)	±1.6@F3.75
Distortion(% max)	<0.1
Telecentricity(° max)	<0.1
I/O(mm)	273±2
Length(mm)	145.5
Mount	C-Mount
Weight(kg)	0.4
Coaxial Light	No
Variable Iris	Yes
Field of View(mm x mm)	
2/3" ICX625/655(8.47x7.1)	28.2x23.7

BTLM-0.3X-110D-23

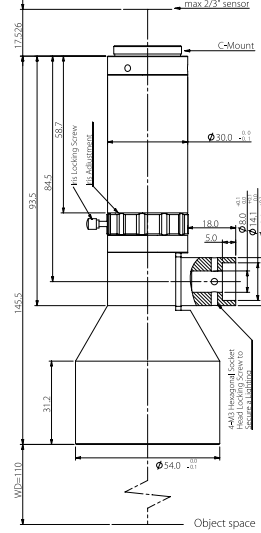

FOV(Φmm)	37
Mag.(x)	0.300
WD(mm)	110±2
Max Sensor Size(Φmm)	11.0(2/3")
F/#	3.75
MTF30(lp/mm)	>220
DoF(mm)	±1.6@F3.75
Distortion(% max)	<0.1
Telecentricity(° max)	<0.1
I/O(mm)	273±2
Length(mm)	145.5
Mount	C-Mount
Weight(kg)	0.4
Coaxial Light	Yes
Variable Iris	Yes
Field of View(mm x mm)	
2/3" ICX625/655(8.47x7.1)	28.2x23.7

BTLM-0.166X-166-23

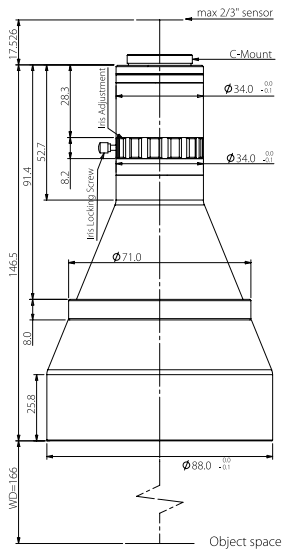

FOV(Φmm)	66
Mag.(x)	0.166
WD(mm)	166±3
Max Sensor Size(Φmm)	11.0(2/3")
F/#	3.3
MTF30(lp/mm)	>260
DoF(mm)	±4.7@F3.3
Distortion(% max)	<0.1
Telecentricity(° max)	<0.1
I/O(mm)	329±3
Length(mm)	146.5
Mount	C-Mount
Weight(kg)	0.6
Coaxial Light	No
Variable Iris	Yes
Field of View(mm x mm)	
2/3" ICX625/655(8.47x7.1)	51.0x42.8